

Report

Licensing Sub-Committee

Part 1

Date: 14 September 2020

Subject **Licensing Application**

Purpose The consideration and decision in respect of an application by Parminder Singh and Tejinder Pal Singh under Section 17 Licensing Act 2003 for the Grant of a Premises Licence in respect of Fair Price, 128 Chepstow Road, Newport, NP19 8EF.

Author Samantha Turnbull

Ward All Wards

Summary The Licensing Committee have statutory and delegated powers to take decisions in relation to licensing applications. The Licensing Committee will make the decision on the application pursuant to the Licensing Act 2003.

Proposal To make a decision on the application as detailed within this report.

Contact Licensing Officer

Action by Head of Law and Regulation

Timetable Statutory Consultation Period

Signed Samantha Turnbull

1. Application

An application made by Parminder Singh and Tejinder Pal Singh under section 17 of the Licensing Act 2003 for the grant of a Premises Licence was served on the Licensing Authority of Newport City Council on 16 July 2020. (A copy of the application can be found in Appendix 1 of this report).

In accordance with statutory provisions, copies of the application were served on each of the responsible authorities and details of the application were advertised on the premises and in the South Wales Argus, giving the responsible authorities and any other persons until midnight on 14 August 2020 to make written representations.

A location map and images of the exterior of the premises are detailed in appendix 4 of this report.

Parminder Singh and Tejinder Pal Singh seek the grant of a Premises Licence that would permit the provision of the licensable activity of the sale by retail of alcohol for consumption 'off the premises'. The application proposes that Parminder Singh is to be specified as the Designated Premises Supervisor and his signed consent is included within a copy of the application (Appendix 1).

2. Licensable Activities

The application seeks to be granted a Premises Licence for the authorisation of :

- Sale of alcohol for consumption off the premises only: Monday to Sunday between the hours of 07:00 – 22:00.

3. Promotion of the Licensing Objectives

The applicant has described in an Operating Schedule, the steps that will be taken to promote the four licensing objectives if the application is granted. These are contained in section 18 of the application form at Appendix 1 to this report.

4. Representations

Responsible Authority Representations

On 17 July 2020 a formal representation (Appendix 2) was received from PC 531 Austin, Police Licensing Officer, Heddlu Gwent Police responsible authority objecting to the application with a proposal that if additional conditions detailed in the representation were agreed by the applicant the objection would be withdrawn.

This representation was forwarded to Parminder Singh and Tejinder Pal Singh on 17 July 2020, who responded on 20 July 2020 agreeing to all of the proposed conditions. This response was communicated to PC 531 Austin who formally withdrew the objection of Heddlu Gwent Police.

Other Person Representations

Representations were also received from 'other persons' and are detailed at Appendix 3.

1. Connor Roberts, 104 Chepstow Road, Newport
2. Emma Lewis, 8 Exeter Road, Newport

3. Josh Gray, 10 Exeter Road, Newport, NP19 8DB
4. Michael Jordan, 64 Archibald Street, Newport
5. K Hackwood, 4 Oxford Street, Newport
6. Antoinette Helmich, Flat 2 Victoria Court, Maindee, Newport
7. Mujahid Ahmed, 185 Chepstow Road, Newport
8. N. Issac, 22 Albert Avenue, Newport
9. Paul Powell, 9 Wharf Road, Newport
10. John Collins, 2 Exeter Road, Newport
11. Tania Roberts, 7 Archibald Street, Newport
12. Joanne and Russell Taylor, 14 Archibald Street, Newport, NP19 8ER
13. J Gibbons, 185 Chepstow Road, Newport
14. James Oliver, 126 Chesptow Road, Newport
15. Mr and Mrs M Bonsall, 65 Archibald Street, Newport, NP19 8ER
16. Mr Lee Wall, 66 Archibald Street, Newport, NP19 8ER
17. Thomas Jeffrey, 48 St Johns Road, Newport
18. Aleksander Ryzinski, Delikatesy ABC, 148 - 152 Chepstow Road, NP19 8EG
19. Iskender-Dogres 123 Chepstow Road, Newport
20. Nadeem Hussain, 26 Livingstone Place, Newport, NP19 8EY
21. Jacqueline Littlejohns, 12 Hereford Street, Newport, NP19 8DT
22. A Hussain, Tamarind, 122 Chepstow Road, Newport, NP19 8EF
23. Stephen Littlejohns, 12 Hereford Street, Newport, NP19 8DT
24. Tony Anderson, 56 Summerhill Avenue, Newport
25. Mr Ramoun Panting, 27 Oxford Street, Newport, NP19 8ES
26. Cuma Elina, 119 Chepstow Road, Newport, NP19 8BZ
27. Jayson Willmott, 6 Kengsington Place, Newport
28. Carl Layton, 109 Victoria Avenue, Newport, NP19 8GF
29. M A Raza, 33 Harrow Road, Newport, NP19 0BL
30. Martin Berry, 5 Jackson Court, Newport
31. Andrew Erskine, Ash Cottage, Mill Lane, Caldicot, NP26 4BN
32. Demebo Wario, 14 Duckpool Road, Newport, NP19 8FH
33. Danielle Wall, 10 Exeter Road, Newport, NP19 8DB
34. Adrian Taylor, 104 Chepstow Road, Newport, NP19 8EE
35. Marcelle Greygans 62 Worcester Crescent, Newport, NP19 7NF
36. Tracy Waddon, 85 Albert Avenue, Newport, NP19 8FF
37. Michael Bevan, 56 Marlborough Road, Newport, NP19 0BY
38. L.H. Sage, 49 Bishton Street, Newport
39. Mr Mohinder Singh, My Maindee Store, 108 Chepstow Road, Newport, NP19 8EE
40. C Bingham, 10 Merriott Place, Newport, NP19 8DA
41. Shamraz Khan, Flat 4, 104 Chepstow Road, Newport, NP19 8EE
42. Jason Bird, 104 Chepstow Road, Newport, NP19 8EE
43. Lee Crupton, Flat 5, 104 Chepstow Road, Newport, NP19 8EE
44. Mr M Maloney, 130 Chepstow Road, Newport, NP19 8EF
45. Lee McDonald, 20 Glebe Street, Newport
46. The Occupier, 24 Sandalwood Court, Newport
47. Gita Amin, 165A Chepstow Road, Newport, NP19 8GH
48. Neyaz Crib, 155 Chepstow Road, Newport
49. Bhavesh Amin, 165A Chepstow Road, Newport, NP19 8GH
50. S Winstone, 228 Chepstow Road, Newport
51. Gonzalo Porras, 38 Kensington Place, NP19 8GL
52. Suzanne Allman, 125 Victoria Avenue, Newport, NP19 8GF
53. Denise Evans, 163A Chepstow Road, Newport, NP19 8GH
54. Aydin Kavak, 151 Chepstow Road, Newport, NP19 8GE
55. Charlotte Parkinson-White, 87 Victoria Avenue, Newport
56. Motor Body Repairs, 149A Chepstow Road, Newport, NP19 8GE
57. Mr K Roberts, 22 Eveswell Court, Newport, NP19 8EJ

- 58. The Occupier, 5 Maindee Parade, NP19 8FJ
- 59. Pepino's, 172 Chepstow Road, Newport, NP19 8EG
- 60. Thomas Dearden, 153A Chepstow Road, Newport, NP19 8GE
- 61. Mortuza Miah, 124 Victoria Avenue, Newport, NP19 8GF

5. Policy Considerations

Relevant extracts of the Statement of Licensing Policy as regards this application include:

IMP 1 The Council will normally grant applications for premises licences and club premises certificates subject to conditions which are consistent with the Operating Schedule and any mandatory conditions prescribed within the Act. Where relevant representations are received the Council may impose additional conditions as considered necessary in order to promote the licensing objectives which arise out of those representations.

IMP 2 The Council will strike a fair balance between the benefits of a licensed premises to a community and the risk of disturbance to local residents. Consequently, in certain areas, upon receipt of representations by any Responsible Authority or any other person, the Council may restrict the hours of operation of licensable activities.

IMP 3 The Council will normally grant premises licences for a time period of not earlier than 10.00 a.m. and a terminal hour of no later than 11.30 p.m. for those premises licensed to sell alcohol for consumption on the premises and which are located in primarily residential areas. However, hours beyond 11.30 p.m. may be permitted:

- a. for premises located in predominantly commercial areas, such as the City Centre and where there is a high level of accessibility to public transport services;

or

- b. the licensable activities would not be likely to cause adverse impact especially on local residents, and that, if there is a potential to cause adverse impact, appropriate measures will be put in place to prevent it;

or

- c. there will not be any increase in the cumulative adverse impact from these or similar activities, on any neighbouring residential area and the activity will not be likely to lead to a demonstrable increase in car parking demand in surrounding residential streets or on roads.

G2 The Council will attach conditions to licences, which are tailored to the individual style and characteristics of the premises. Such conditions will normally be drawn from the Council's pool of conditions. Where appropriate, additional conditions will be formulated based on an individual case following receipt of relevant representations.

6. Legal Considerations

The decision must be taken following consideration of the representations received with a view to promoting the licensing objectives which are:

- a. Prevention of crime and disorder
- b. Public Safety
- c. Prevention of Public Nuisance
- d. Protection of Children from Harm

In each case the Sub-Committee may make the following determination:

- a. To grant the application as applied
- b. To grant the application and modify what is requested by the application in respect of activities, times and conditions, by altering, omitting or adding to them, where relevant.
- c. Reject the whole or part of the application.

All decisions taken by the Sub-Committee must

- a. be within the legal powers of the Council and its Committees;
- b. comply with any procedural requirement imposed by law;
- c. be undertaken in accordance with the procedural requirements imposed by the Council eg. standing orders and financial regulations;
- d. be fully and properly informed;
- e. be properly motivated;
- f. be taken having regard to the Council's fiduciary duty to its taxpayers; and
- g. be reasonable and proper in all the circumstances.

7. Issues for discussion

- a) The proposed licensable activity and permitted hours sought by the application.
- b) The content of the operating schedule in promoting the four licensing objectives.
- c) The representations made in respect of the application.
- d) Newport City Council's Statement of Licensing Policy 2015

8. List of Appendices

1. Application for Grant of a Premises Licence, including plan and DPS consent form.
2. Representation from Responsible Authority (Heddlu Gwent Police).
3. Representations from 'Other Persons'.
4. Location Map and images of exterior of premises.

9. Financial Summary

- The costs and financial implications: You must discuss financial implications with the Head of Finance and the report must identify from where your proposals will be funded, together with any impact on budgets or any opportunity costs

	Year 1 (Current) £	Year 2 £	Year 3 £	Ongoing £	Notes including budgets heads affected
Costs (Income)					
Net Costs (Savings)					
Net Impact					

on Budget				
------------------	--	--	--	--

Risks

It is important to identify and manage any project or scheme's exposure to risk and have in place controls to deal with those risks.

In this section, you should consider the key risks facing the proposals in your report, particularly those which would impact on delivery or sustainability of the project of projected outcomes. You will need to include details of how risks will be managed. If your proposals rely on short or medium term grant aid or funding streams you will need to outline your exit or continuation policy here.

You will need to complete the following Risk table

Risk	Impact of Risk if it occurs* (H/M/L)	Probability of risk occurring (H/M/L)	What is the Council doing or what has it done to avoid the risk or reduce its effect	Who is responsible for dealing with the risk?
Making a unlawful decision	High	Low	The Committee will consult with the Legal Officer and Licensing Officer to determine if any decision is lawful and proportionate. Members training.	Chairperson. Legal Officer.
The licensing committee departing from the licensing policy.	Medium	Low	If the Committee wishes to depart from the Councils policy they must give good reason for this and obtain advice from the Legal Officer when departing from the Policies to ensure the decision is lawful. Members training.	Chairperson. Legal Officer.
The applicant does not have a fair hearing	High	Low	A Licensing Committee procedure should be followed by the committee. The Legal Officer alongside the Democratic Service Officer will advise the committee if at any stage an unfair hearing is taking place. Members training.	Democratic Service Officer. Chairperson. Legal Officer.

* Taking account of proposed mitigation measures

Links to Council Policies and Priorities

This report has been prepared in accordance with The Licensing Act 2003 and with regard to Newport City Council Statement of Licensing Policies 2015.

Options Available

- To grant the application as applied.
- To grant the application and modify what is requested by the application in respect of times and conditions, by altering, omitting or adding to them, where relevant.
- Reject the whole or part of the application.

APPENDIX 1

Copy of application for Grant of a Premises Licence at Fair Price, 128 Chepstow Road, Newport, NP19 8EF



Newport
Application for a premises licence
Licensing Act 2003

For help contact
environment.licensing@newport.gov.uk
Telephone: 01633 656656

* required information

Section 1 of 21

You can save the form at any time and resume it later. You do not need to be logged in when you resume.

System reference This is the unique reference for this application generated by the system.

Your reference You can put what you want here to help you track applications if you make lots of them. It is passed to the authority.

Are you an agent acting on behalf of the applicant?

Yes No

Put "no" if you are applying on your own behalf or on behalf of a business you own or work for.

Applicant Details

* First name

* Family name

* E-mail

Main telephone number Include country code.

Other telephone number

Indicate here if you would prefer not to be contacted by telephone

Are you:

Applying as a business or organisation, including as a sole trader
 Applying as an individual

A sole trader is a business owned by one person without any special legal structure. Applying as an individual means you are applying so you can be employed, or for some other personal reason, such as following a hobby.

Applicant Business

Is your business registered in the UK with Companies House? Yes No

Note: completing the Applicant Business section is optional in this form.

Is your business registered outside the UK? Yes No

Business name If your business is registered, use its registered name.

VAT number Put "none" if you are not registered for VAT.

Legal status

Continued from previous page...

Your position in the business

Home country

The country where the headquarters of your business is located.

Business Address

If you have one, this should be your official address - that is an address required of you by law for receiving communications.

Building number or name

Street

District

City or town

County or administrative area

Postcode

Country

Section 2 of 21

PREMISES DETAILS

I/we, as named in section 1, apply for a premises licence under section 17 of the Licensing Act 2003 for the premises described in section 2 below (the premises) and I/we are making this application to you as the relevant licensing authority in accordance with section 12 of the Licensing Act 2003.

Premises Address

Are you able to provide a postal address, OS map reference or description of the premises?

- Address OS map reference Description

Postal Address Of Premises

Building number or name

Street

District

City or town

County or administrative area

Postcode

Country

Further Details

Telephone number

Non-domestic rateable value of premises (£)

Section 3 of 21**APPLICATION DETAILS**

In what capacity are you applying for the premises licence?

- An individual or individuals
- A limited company / limited liability partnership
- A partnership (other than limited liability)
- An unincorporated association
- Other (for example a statutory corporation)
- A recognised club
- A charity
- The proprietor of an educational establishment
- A health service body
- A person who is registered under part 2 of the Care Standards Act 2000 (c14) in respect of an independent hospital in Wales
- A person who is registered under Chapter 2 of Part 1 of the Health and Social Care Act 2008 in respect of the carrying on of a regulated activity (within the meaning of that Part) in an independent hospital in England
- The chief officer of police of a police force in England and Wales

Confirm The Following

- I am carrying on or proposing to carry on a business which involves the use of the premises for licensable activities
- I am making the application pursuant to a statutory function
- I am making the application pursuant to a function discharged by virtue of Her Majesty's prerogative

Section 4 of 21**NON INDIVIDUAL APPLICANTS**

Provide name and registered address of applicant in full. Where appropriate give any registered number. In the case of a partnership or other joint venture (other than a body corporate), give the name and address of each party concerned.

Non Individual Applicant's Name

Name

Details

Registered number (where applicable)

Description of applicant (for example partnership, company, unincorporated association etc)

Continued from previous page...

Partnership

Address

Building number or name

Street

District

City or town

County or administrative area

Postcode

Country

Contact Details

E-mail

Telephone number

Other telephone number

* Date of birth

* Nationality [Documents that demonstrate entitlement to work in the UK](#)

Add another applicant

Section 5 of 21

OPERATING SCHEDULE

When do you want the premises licence to start? / /
dd mm yyyy

If you wish the licence to be valid only for a limited period, when do you want it to end / /
dd mm yyyy

Provide a general description of the premises

For example the type of premises, its general situation and layout and any other information which could be relevant to the licensing objectives. Where your application includes off-supplies of alcohol and you intend to provide a place for consumption of these off-supplies you must include a description of where the place will be and its proximity to the premises.

Continued from previous page...

If 5,000 or more people are expected to attend the premises at any one time, state the number expected to attend

Section 6 of 21

PROVISION OF PLAYS

[See guidance on regulated entertainment](#)

Will you be providing plays?

- Yes No

Section 7 of 21

PROVISION OF FILMS

[See guidance on regulated entertainment](#)

Will you be providing films?

- Yes No

Section 8 of 21

PROVISION OF INDOOR SPORTING EVENTS

[See guidance on regulated entertainment](#)

Will you be providing indoor sporting events?

- Yes No

Section 9 of 21

PROVISION OF BOXING OR WRESTLING ENTERTAINMENTS

[See guidance on regulated entertainment](#)

Will you be providing boxing or wrestling entertainments?

- Yes No

Section 10 of 21

PROVISION OF LIVE MUSIC

[See guidance on regulated entertainment](#)

Will you be providing live music?

- Yes No

Section 11 of 21

PROVISION OF RECORDED MUSIC

[See guidance on regulated entertainment](#)

Will you be providing recorded music?

- Yes No

Section 12 of 21

PROVISION OF PERFORMANCES OF DANCE

[See guidance on regulated entertainment](#)

Will you be providing performances of dance?

Continued from previous page...

Section 13 of 21

PROVISION OF ANYTHING OF A SIMILAR DESCRIPTION TO LIVE MUSIC, RECORDED MUSIC OR PERFORMANCES OF DANCE

[See guidance on regulated entertainment](#)

Will you be providing anything similar to live music, recorded music or performances of dance?

Yes No

Section 14 of 21

LATE NIGHT REFRESHMENT

Will you be providing late night refreshment?

Yes No

Section 15 of 21

SUPPLY OF ALCOHOL

Will you be selling or supplying alcohol?

Yes No

Standard Days And Timings

MONDAY

Start

End

Start

End

Give timings in 24 hour clock.
(e.g., 16:00) and only give details for the days
of the week when you intend the premises
to be used for the activity.

TUESDAY

Start

End

Start

End

WEDNESDAY

Start

End

Start

End

THURSDAY

Start

End

Start

End

FRIDAY

Start

End

Start

End

SATURDAY

Start

End

Start

End

Continued from previous page...

SUNDAY

Start

End

Start

End

Will the sale of alcohol be for consumption:

- On the premises Off the premises Both

If the sale of alcohol is for consumption on the premises select on, if the sale of alcohol is for consumption away from the premises select off. If the sale of alcohol is for consumption on the premises and away from the premises select both.

State any seasonal variations

For example (but not exclusively) where the activity will occur on additional days during the summer months.

Non-standard timings. Where the premises will be used for the supply of alcohol at different times from those listed in the column on the left, list below

For example (but not exclusively), where you wish the activity to go on longer on a particular day e.g. Christmas Eve.

State the name and details of the individual whom you wish to specify on the licence as premises supervisor

Name

First name

Family name

Date of birth

dd mm yyyy

Continued from previous page...

Enter the contact's address

Building number or name	<input type="text"/>
Street	<input type="text"/>
District	<input type="text"/>
City or town	<input type="text"/>
County or administrative area	<input type="text"/>
Postcode	<input type="text"/>
Country	<input type="text"/>
Personal Licence number (if known)	<input type="text" value="NCC-20-1135"/>
Issuing licensing authority (if known)	<input type="text" value="Newport City Council"/>

PROPOSED DESIGNATED PREMISES SUPERVISOR CONSENT

How will the consent form of the proposed designated premises supervisor be supplied to the authority?

- Electronically, by the proposed designated premises supervisor
- As an attachment to this application

Reference number for consent form (if known)

If the consent form is already submitted, ask the proposed designated premises supervisor for its 'system reference' or 'your reference'.

Section 16 of 21

ADULT ENTERTAINMENT

Highlight any adult entertainment or services, activities, or other entertainment or matters ancillary to the use of the premises that may give rise to concern in respect of children

Give information about anything intended to occur at the premises or ancillary to the use of the premises which may give rise to concern in respect of children, regardless of whether you intend children to have access to the premises, for example (but not exclusively) nudity or semi-nudity, films for restricted age groups etc gambling machines etc.

Section 17 of 21

HOURS PREMISES ARE OPEN TO THE PUBLIC

Standard Days And Timings

MONDAY

Start

End

Start

End

Give timings in 24 hour clock. (e.g., 16:00) and only give details for the days of the week when you intend the premises to be used for the activity.

Continued from previous page...

TUESDAY

Start

End

Start

End

WEDNESDAY

Start

End

Start

End

THURSDAY

Start

End

Start

End

FRIDAY

Start

End

Start

End

SATURDAY

Start

End

Start

End

SUNDAY

Start

End

Start

End

State any seasonal variations

For example (but not exclusively) where the activity will occur on additional days during the summer months.

Non standard timings. Where you intend to use the premises to be open to the members and guests at different times from those listed in the column on the left, list below

For example (but not exclusively), where you wish the activity to go on longer on a particular day e.g. Christmas Eve.

Section 18 of 21

LICENSING OBJECTIVES

Describe the steps you intend to take to promote the four licensing objectives:

a) General – all four licensing objectives (b,c,d,e)

Continued from previous page...

List here steps you will take to promote all four licensing objectives together.

The licensee that is the person in whose name the premises licence is issued, shall ensure that all times when the premises are for any licensable activity, there are sufficient competent staff on duty at the premises for the purpose of fulfilling the terms and conditions of the licence and for preventing crime and disorder. The licensee shall ensure that all staff will undertake training in their responsibilities in relation to the sale of alcohol, particularly with regard to drunkenness and underage persons. Records will be kept of training and refresher training.

b) The prevention of crime and disorder

Any incidents of a criminal nature that may occur on the premises will be reported to the police. The licensee will install comprehensive CCTV coverage at the premises and it is operated and maintained at the premises. Cameras must be sited to observe the entrance and exit doors both inside and outside. Have signage displayed in the customer area to advise that CCTV is in operation. Digital images must be kept for 31 days. Police will have access to images any reasonable time. Copies must be made available to police on request.

c) Public safety

Appropriate fire safety procedures are in place including fire extinguishers, fire blanket, internally illuminated fire exit signs, numerous smoke detectors and emergency lighting. All appliances are inspected annually. All emergency exits shall be kept free from obstruction at all times.

d) The prevention of public nuisance

All customers will be asked to leave quietly. Clear and legible notices will be prominently displayed to remind customers to leave quietly and have regard to our neighbours.

e) The protection of children from harm

The licensee and staff will ask persons who appear to be under the age of 25 for photographic ID such as proof of age cards, the Connexions card and Citizen Card, photographic driving licence or passport, an official identity card issued by HM Forces or by an EU country, bearing the photograph and date of birth of bearer. All staff will be trained for UNDERAGE SALES PREVENTION regularly. A register of refused sales shall be kept and maintained on the premises.

Section 19 of 21

NOTES ON DEMONSTRATING ENTITLEMENT TO WORK IN THE UK

Continued from previous page...

Entitlement to work/immigration status for individual applicants and applications from partnerships which are not limited liability partnerships:

A licence may not be held by an individual or an individual in a partnership who is resident in the UK who:

- does not have the right to live and work in the UK; or
- is subject to a condition preventing him or her from doing work relating to the carrying on of a licensable activity.

Any premises licence issued in respect of an application made on or after 6 April 2017 will become invalid if the holder ceases to be entitled to work in the UK.

Applicants must demonstrate that they have an entitlement to work in the UK and are not subject to a condition preventing them from doing work relating to the carrying on of a licensable activity. They do this in one of two ways: 1) by providing with this application copies or scanned copies of the documents listed below (which do not need to be certified), or 2) by providing their 'share code' to enable the licensing authority to carry out a check using the Home Office online right to work checking service (see below).

Documents which demonstrate entitlement to work in the UK

- An expired or current passport showing the holder, or a person named in the passport as the child of the holder, is a British citizen or a citizen of the UK and Colonies having the right of abode in the UK [please see note below about which sections of the passport to copy].
- An expired or current passport or national identity card showing the holder, or a person named in the passport as the child of the holder, is a national of a European Economic Area country or Switzerland.
- A Registration Certificate or document certifying permanent residence issued by the Home Office to a national of a European Economic Area country or Switzerland.
- A Permanent Residence Card issued by the Home Office to the family member of a national of a European Economic Area country or Switzerland.
- A **current** Biometric Immigration Document (Biometric Residence Permit) issued by the Home Office to the holder indicating that the person named is allowed to stay indefinitely in the UK, or has no time limit on their stay in the UK.
- A **current** passport endorsed to show that the holder is exempt from immigration control, is allowed to stay indefinitely in the UK, has the right of abode in the UK, or has no time limit on their stay in the UK.
- A **current** Immigration Status Document issued by the Home Office to the holder with an endorsement indicating that the named person is allowed to stay indefinitely in the UK or has no time limit on their stay in the UK, **when produced in combination with** an official document giving the person's permanent National Insurance number and their name issued by a Government agency or a previous employer.
- A birth or adoption certificate issued in the UK, **when produced in combination with** an official document giving the person's permanent National Insurance number and their name issued by a Government agency or a previous employer.
- A birth or adoption certificate issued in the Channel Islands, the Isle of Man or Ireland **when produced in combination with** an official document giving the person's permanent National Insurance number and their name issued by a Government agency or a previous employer.
- A certificate of registration or naturalisation as a British citizen, **when produced in combination with** an official document giving the person's permanent National Insurance number and their name issued by a Government agency or a previous employer.

Continued from previous page...

- A **current** passport endorsed to show that the holder is allowed to stay in the UK and is currently allowed to work and is not subject to a condition preventing the holder from doing work relating to the carrying on of a licensable activity.
- A **current** Biometric Immigration Document (Biometric Residence Permit) issued by the Home Office to the holder which indicates that the named person can currently stay in the UK and is allowed to work relation to the carrying on of a licensable activity.
- A **current** Residence Card issued by the Home Office to a person who is not a national of a European Economic Area state or Switzerland but who is a family member of such a national or who has derivative rights or residence.
- A **current** Immigration Status Document containing a photograph issued by the Home Office to the holder with an endorsement indicating that the named person may stay in the UK, and is allowed to work and is not subject to a condition preventing the holder from doing work relating to the carrying on of a licensable activity **when produced in combination with** an official document giving the person's permanent National Insurance number and their name issued by a Government agency or a previous employer.
- A Certificate of Application, **less than 6 months old**, issued by the Home Office under regulation 18(3) or 20(2) of the Immigration (European Economic Area) Regulations 2016, to a person who is not a national of a European Economic Area state or Switzerland but who is a family member of such a national or who has derivative rights of residence.
- Reasonable evidence that the person has an outstanding application to vary their permission to be in the UK with the Home Office such as the Home Office acknowledgement letter or proof of postage evidence, or reasonable evidence that the person has an appeal or administrative review pending on an immigration decision, such as an appeal or administrative review reference number.
- Reasonable evidence that a person who is not a national of a European Economic Area state or Switzerland but who is a family member of such a national or who has derivative rights of residence in exercising treaty rights in the UK including:-
 - evidence of the applicant's own identity – such as a passport,
 - evidence of their relationship with the European Economic Area family member – e.g. a marriage certificate, civil partnership certificate or birth certificate, and
 - evidence that the European Economic Area national has a right of permanent residence in the UK or is one of the following if they have been in the UK for more than 3 months:
 - (i) working e.g. employment contract, wage slips, letter from the employer,
 - (ii) self-employed e.g. contracts, invoices, or audited accounts with a bank,
 - (iii) studying e.g. letter from the school, college or university and evidence of sufficient funds; or
 - (iv) self-sufficient e.g. bank statements.

Family members of European Economic Area nationals who are studying or financially independent must also provide evidence that the European Economic Area national and any family members hold comprehensive sickness insurance in the UK. This can include a private medical insurance policy, an EHIC card or an S1, S2 or S3 form.

Original documents must not be sent to licensing authorities. If the document copied is a passport, a copy of the following pages should be provided:-

- (i) any page containing the holder's personal details including nationality;
- (ii) any page containing the holder's photograph;
- (iii) any page containing the holder's signature;
- (iv) any page containing the date of expiry; and
- (v) any page containing information indicating the holder has permission to enter or remain in the UK and is permitted to work.

Continued from previous page...

If the document is not a passport, a copy of the whole document should be provided.

Your right to work will be checked as part of your licensing application and this could involve us checking your immigration status with the Home Office. We may otherwise share information with the Home Office. Your licence application will not be determined until you have complied with this guidance.

Home Office online right to work checking service

As an alternative to providing a copy of the documents listed above, applicants may demonstrate their right to work by allowing the licensing authority to carry out a check with the Home Office online right to work checking service.

To demonstrate their right to work via the Home Office online right to work checking service, applicants should include in this application their 9-digit share code (provided to them upon accessing the service at <https://www.gov.uk/prove-right-to-work>) which, along with the applicant's date of birth (provided within this application), will allow the licensing authority to carry out the check.

In order to establish the applicant's right to work, the check will need to indicate that the applicant is allowed to work in the United Kingdom and is not subject to a condition preventing them from doing work relating to the carrying on of a licensable activity.

An online check will not be possible in all circumstances because not all applicants will have an immigration status that can be checked online. The Home Office online right to work checking service sets out what information and/or documentation applicants will need in order to access the service. Applicants who are unable to obtain a share code from the service should submit copy documents as set out above.

Section 20 of 21

NOTES ON REGULATED ENTERTAINMENT

Continued from previous page...

In terms of specific **regulated entertainments** please note that:

- Plays: no licence is required for performances between 08:00 and 23.00 on any day, provided that the audience does not exceed 500.
- Films: no licence is required for 'not-for-profit' film exhibition held in community premises between 08.00 and 23.00 on any day provided that the audience does not exceed 500 and the organiser (a) gets consent to the screening from a person who is responsible for the premises; and (b) ensures that each such screening abides by age classification ratings.
- Indoor sporting events: no licence is required for performances between 08.00 and 23.00 on any day, provided that the audience does not exceed 1000.
- Boxing or Wrestling Entertainment: no licence is required for a contest, exhibition or display of Greco-Roman wrestling, or freestyle wrestling between 08.00 and 23.00 on any day, provided that the audience does not exceed 1000. Combined fighting sports – defined as a contest, exhibition or display which combines boxing or wrestling with one or more martial arts – are licensable as a boxing or wrestling entertainment rather than an indoor sporting event.
- Live music: no licence permission is required for:
 - o a performance of unamplified live music between 08.00 and 23.00 on any day, on any premises.
 - o a performance of amplified live music between 08.00 and 23.00 on any day on premises authorised to sell alcohol for consumption on those premises, provided that the audience does not exceed 500.
 - o a performance of amplified live music between 08.00 and 23.00 on any day, in a workplace that is not licensed to sell alcohol on those premises, provided that the audience does not exceed 500.
 - o a performance of amplified live music between 08.00 and 23.00 on any day, in a church hall, village hall, community hall, or other similar community premises, that is not licensed by a premises licence to sell alcohol, provided that (a) the audience does not exceed 500, and (b) the organiser gets consent for the performance from a person who is responsible for the premises.
 - o a performance of amplified live music between 08.00 and 23.00 on any day, at the non-residential premises of (i) a local authority, or (ii) a school, or (iii) a hospital, provided that (a) the audience does not exceed 500, and (b) the organiser gets consent for the performance on the relevant premises from: (i) the local authority concerned, or (ii) the school or (iii) the health care provider for the hospital.
- Recorded Music: no licence permission is required for:
 - o any playing of recorded music between 08.00 and 23.00 on any day on premises authorised to sell alcohol for consumption on those premises, provided that the audience does not exceed 500.
 - o any playing of recorded music between 08.00 and 23.00 on any day, in a church hall, village hall, community hall, or other similar community premises, that is not licensed by a premises licence to sell alcohol, provided that (a) the audience does not exceed 500, and (b) the organiser gets consent for the performance from a person who is responsible for the premises.
 - o any playing of recorded music between 08.00 and 23.00 on any day, at the non-residential premises of (i) a local authority, or (ii) a school, or (iii) a hospital, provided that (a) the audience does not exceed 500, and (b) the organiser gets consent for the performance on the relevant premises from: (i) the local authority concerned, or (ii) the school proprietor or (iii) the health care provider for the hospital.

Continued from previous page...

- Dance: no licence is required for performances between 08.00 and 23.00 on any day, provided that the audience does not exceed 500. However, a performance which amounts to adult entertainment remains licensable.
- Cross activity exemptions: no licence is required between 08.00 and 23.00 on any day, with no limit on audience size for:
 - o any entertainment taking place on the premises of the local authority where the entertainment is provided by or on behalf of the local authority;
 - o any entertainment taking place on the hospital premises of the health care provider where the entertainment is provided by or on behalf of the health care provider;
 - o any entertainment taking place on the premises of the school where the entertainment is provided by or on behalf of the school proprietor; and
 - o any entertainment (excluding films and a boxing or wrestling entertainment) taking place at a travelling circus, provided that (a) it takes place within a moveable structure that accommodates the audience, and (b) that the travelling circus has not been located on the same site for more than 28 consecutive days.

Section 21 of 21

PAYMENT DETAILS

This fee must be paid to the authority. If you complete the application online, you must pay it by debit or credit card.

Premises Licence Fees are determined by the non domestic rateable value of the premises.

To find out a premises non domestic rateable value go to the Valuation Office Agency site at http://www.voa.gov.uk/business_rates/index.htm

Band A (No RV to £4300) the fee is £100.00
Band B (£4301 to £33000) the fee is £190.00
Band C (£33001 to £87000) the fee is £315.00
Band D (£87001 to £125000) the fee is £450.00*
Band E (£125001 and over) the fee is £635.00*

*If the premises rateable value is in Bands D or E and the premises is primarily used for the consumption of alcohol on the premises then you are required to pay a higher fee as follows:

Band D (£87001 to £125000) the fee is £900.00
Band E (£125001 and over) the fee is £1,905.00

There is an exemption from the payment of fees in relation to the provision of regulated entertainment at church halls, chapel halls or premises of a similar nature, village halls, parish or community halls, or other premises of a similar nature. If, however, the licence also authorises the use of the premises for the supply of alcohol or the provision of late night refreshment, a fee will be required.

Schools and sixth form colleges are exempt from the fees associated with the Premises Licence that authorises the provision of regulated entertainment only, where the entertainment is provided by and at the school or college, and for educational purposes.

If you operate a large event you are subject to ADDITIONAL fees based upon the number in attendance at any one time:

Capacity 5000-9999	£1,000.00
Capacity 10000 -14999	£2,000.00
Capacity 15000-19999	£4,000.00
Capacity 20000-29999	£8,000.00
Capacity 30000-39999	£16,000.00
Capacity 40000-49999	£24,000.00
Capacity 50000-59999	£32,000.00
Capacity 60000-69999	£40,000.00
Capacity 70000-79999	£48,000.00
Capacity 80000-89999	£56,000.00
Capacity 90000 and over	£64,000.00

Continued from previous page...

* Fee amount (£)

DECLARATION

* I/we understand it is an offence, liable on conviction to a fine up to level 5 on the standard scale, under section 158 of the licensing act 2003, to make a false statement in or in connection with this application.

Ticking this box indicates you have read and understood the above declaration

Continued from previous page...

This section should be completed by the applicant, unless you answered "Yes" to the question "Are you an agent acting on behalf of the applicant?"

* Full name
* Capacity
* Date / /
dd mm yyyy

* Full name
* Capacity
* Date / /
dd mm yyyy

Once you're finished you need to do the following:

1. Save this form to your computer by clicking file/save as...
2. Go back to <https://www.gov.uk/apply-for-a-licence/premises-licence/newport/apply-1> to upload this file and continue with your application.

Don't forget to make sure you have all your supporting documentation to hand.

IT IS AN OFFENCE LIABLE TO SUMMARY CONVICTION TO A FINE OF ANY AMOUNT UNDER SECTION 158 OF THE LICENSING ACT 2003, TO MAKE A FALSE STATEMENT IN OR IN CONNECTION WITH THIS APPLICATION

IT IS AN OFFENCE UNDER SECTION 24B OF THE IMMIGRATION ACT 1971 FOR A PERSON TO WORK WHEN THEY KNOW, OR HAVE REASONABLE CAUSE TO BELIEVE, THAT THEY ARE DISQUALIFIED FROM DOING SO BY REASON OF THEIR IMMIGRATION STATUS. THOSE WHO EMPLOY AN ADULT WITHOUT LEAVE OR WHO IS SUBJECT TO CONDITIONS AS TO EMPLOYMENT WILL BE LIABLE TO A CIVIL PENALTY UNDER SECTION 15 OF THE IMMIGRATION, ASYLUM AND NATIONALITY ACT 2006 AND PURSUANT TO SECTION 21 OF THE SAME ACT, WILL BE COMMITTING AN OFFENCE WHERE THEY DO SO IN THE KNOWLEDGE, OR WITH REASONABLE CAUSE TO BELIEVE, THAT THE EMPLOYEE IS DISQUALIFIED



* required information

Section 1 of 3

You can save the form at any time and resume it later. You do not need to be logged in when you resume.

System reference	<input type="text" value="Not Currently In Use"/>	This is the unique reference for this application generated by the system.
Your reference	<input type="text" value="FPRICE21"/>	You can put what you want here to help you track applications if you make lots of them. It is passed to the authority.
Are you an agent acting on behalf of the applicant?	<input type="radio"/> Yes <input checked="" type="radio"/> No	Put "no" if you are applying on your own behalf or on behalf of a business you own or work for.

Applicant Details

* First name	<input type="text" value="Parminder"/>	
* Family name	<input type="text" value="Singh"/>	
* E-mail	<input type="text" value="[REDACTED]"/>	
Main telephone number	<input type="text" value="[REDACTED]"/>	Include country code.
Other telephone number	<input type="text"/>	
<input type="checkbox"/> Indicate here if you would prefer not to be contacted by telephone		
Are you:	<input checked="" type="radio"/> Applying as a business or organisation, including as a sole trader <input type="radio"/> Applying as an individual	A sole trader is a business owned by one person without any special legal structure. Applying as an individual means you are applying so you can be employed, or for some other personal reason, such as following a hobby.

Applicant Business

Is your business registered in the UK with Companies House?	<input type="radio"/> Yes <input checked="" type="radio"/> No	Note: completing the Applicant Business section is optional in this form.
Is your business registered outside the UK?	<input type="radio"/> Yes <input checked="" type="radio"/> No	
Business name	<input type="text"/>	If your business is registered, use its registered name.
VAT number	<input type="text" value="-"/>	Put "none" if you are not registered for VAT.
Legal status	<input type="text" value="Partnership"/>	

Continued from previous page...

Your position in the business

Home country

The country where the headquarters of your business is located.

Business Address

If you have one, this should be your official address - that is an address required of you by law for receiving communications.

Building number or name

Street

District

City or town

County or administrative area

Postcode

Country



* required information

Section 2 of 3

CONSENT

Name Of Proposed Premises Supervisor

* First name

* Family name

Address Of Proposed Premises

* Building number or name

* Street

District

* City or town

County or administrative area

Postcode

* Country

I hereby confirm that I give my consent to be specified as the designated premises supervisor in relation to the following application, and any premises licence to be granted or varied in respect of this application concerning the supply of alcohol at the premises

* Type of application For instance 'Application for a premises licence' or 'Variation of a premises licence'

Is the application or variation that this consent is being submitted in connection with being supplied electronically to the authority

Yes No Don't know

Reference number of electronic application (if known) If the application or variation form is already submitted, ask its applicant for the form's 'system reference' or 'your reference'.

Premises Licence Holder

* Name

Continued from previous page...

Address Of Premises

* Building number or name	<input type="text" value="128"/>
* Street	<input type="text" value="Chepstow Road"/>
District	<input type="text"/>
* City or town	<input type="text" value="Newport Gwent"/>
County or administrative area	<input type="text"/>
Postcode	<input type="text" value="NP19 8EF"/>

Premises

Premise licence number	<input type="text"/>
* Name of premises	<input type="text" value="Fair Price"/>

I also confirm that I am applying for, intend to apply for or currently hold a personal licence, details of which I set out below

Personal licence number	<input type="text" value="NCC-20-1135"/>
Personal licence issuing authority name	<input type="text" value="Newport City Council"/>

Address Of Personal Licence Issuing Authority

Building number or name	<input type="text" value="Information Station"/>
Street	<input type="text" value="Queensway"/>
District	<input type="text"/>
City or town	<input type="text" value="Newport Gwent"/>
County or administrative area	<input type="text"/>
Postcode	<input type="text" value="NP20 4AX"/>

Contact Details Of Personal Licence Issuing Authority

Telephone number	<input type="text" value="01633656656"/>
------------------	--



* required information

Section 3 of 3

DECLARATION

* I/we understand it is an offence, liable on conviction to a fine up to level 5 on the standard scale, under section 158 of the licensing act 2003, to make a false statement in or in connection with this application.

Ticking this box indicates you have read and understood the above declaration

This section should be completed by the applicant, unless you answered "Yes" to the question "Are you an agent acting on behalf of the applicant?"

* Full name
* Capacity
* Date / /
dd mm yyyy

* Full name
* Capacity
* Date / /
dd mm yyyy

Once you're finished you need to do the following:

1. Save this form to your computer by clicking file/save as...
2. Go back to <https://www.gov.uk/apply-for-a-licence/premises-licence/newport/change-7> to upload this file and continue with your application.

Don't forget to make sure you have all your supporting documentation to hand.

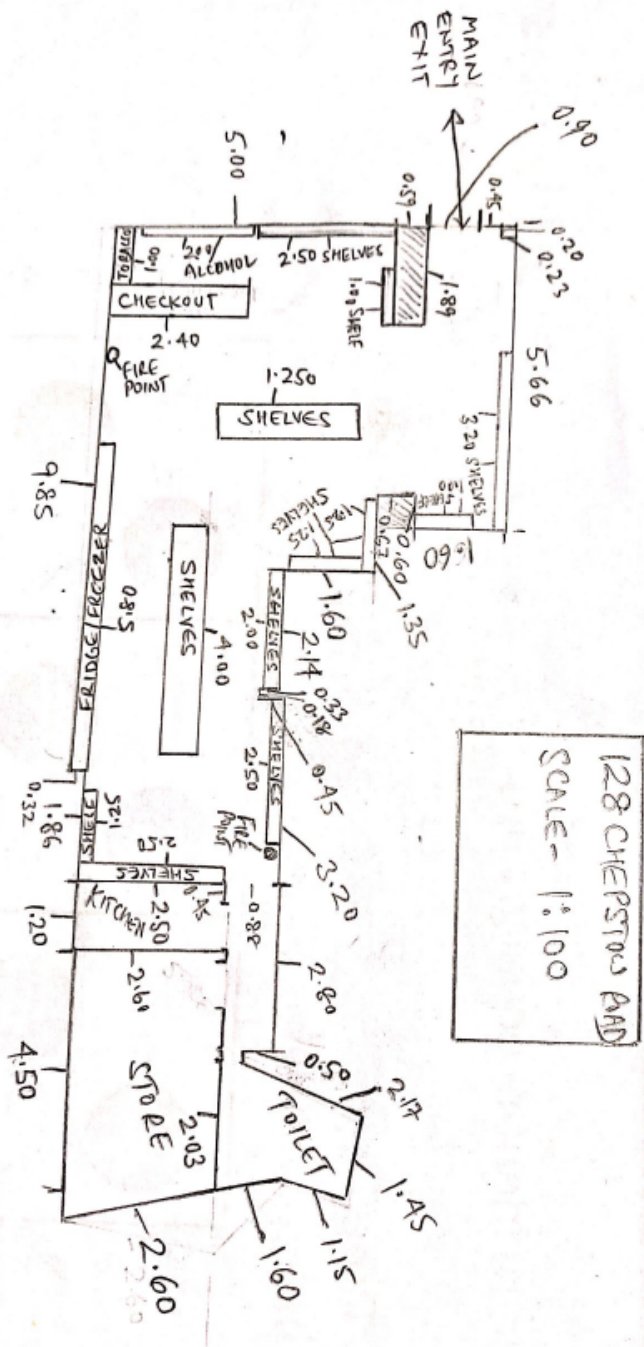

APPENDIX 2

Representation served by PC 531 Austin, Police Licensing Officer, Heddlu Gwent Police - Responsible Authority



HEDDLU GWENT POLICE

RELEVANT REPRESENTATIONS
PREMISES LICENCE / CLUB PREMISES CERTIFICATE
UNDER S. 17 OF THE LICENSING ACT 2003

Representations by the Police to be made within 28 Days of receipt of the application.

Date application received: **14TH July 2020**

Date representations sent to Licensing Authority: **17th July 2020**

Name of authority: **Newport County Council**

Premises Name and address: **Fair Price, 128 Chepstow Road, Newport, NP19 8EF**

Applicant's Name: **Parminder Singh & Tejinder Singh**

Applicant's Contact Address: **[REDACTED]**

Representations made on the following grounds due to undermining of one or more of the Licensing Objectives.

The Prevention of Crime and Disorder, Public Safety, The Prevention of Public Nuisance, The Protection of Children from Harm

This application for a new Premises Licence has been considered by Gwent Police and contact made with the applicant. To clarify, it is the wish of the applicant that the opening hours of the premises will be 06:00 hours to 22:00 hours Monday – Sunday and that alcohol sales will start from 07:00 hours until 22:00 hours Monday – Sunday.

It is the opinion of Gwent Police that the application in its original form could undermine the licensing objectives. Gwent Police would ask that the following conditions be added.

- (i) The CCTV equipment shall be maintained in good working order and continually record when licensable activity takes place.
- (ii) The premises licence holder shall ensure images from the CCTV are retained for a period of 31 days. This image retention period may be reviewed as appropriate by the Licensing Authority and any other authorised person.
- (iii) The correct time and date will be generated onto both the recording and the real time image screen;
- (iv) If the CCTV equipment (including any mobile units in use at the premises) breaks down the Premises Licence Holder shall ensure the designated premises supervisor, or in his/her absence other responsible person, verbally informs the Licensing Authority and the Police as soon as is reasonably practicable. This information shall be contemporaneously recorded in the incident report register and shall include the time, date and means this was done and to whom the information was reported. Equipment failures shall be repaired or replaced as soon as is reasonably practicable and without undue delay. The Licensing Authority and the Police shall be informed when faults are rectified;
- (v) The premise licence holder shall ensure that there are trained members of staff available during licensable hours to be able to reproduce and download CCTV images into a removable format at the request of any authorised officer of the Licensing Authority or a constable;
- (vi) There shall be clear signage indicating that CCTV equipment is in use and recording at the premises.
- (vii) Alcohol sales will not start until 09:00 hours. As it stands, 07:00 hours is not acceptable due to the fact many pubs / clubs in the city centre have a licence until 06:00 hours so there is nothing stopping intoxicated persons from attending this location and purchasing more alcohol which would undermine one or more of the licensing objectives. If the applicant does not agree with a 09:00 hours start time for the sale of alcohol then Gwent Police would require SIA registered door staff to be in place between the hours of 07:00 and 09:00.
- (viii) The Premises Licence Holder shall operate and maintain an up-to-date Register of Refusals of Sale of Alcohol, indicating the date, time and reason for refusal which shall be made available for inspection by any Responsible Authority under the Licensing Act 2003. The DPS shall check the book once a month ensuring that it is complete and up to date. The DPS will sign the book each time it is checked.
- (ix) The premises shall operate a Challenge 25 policy and signage will be displayed to indicate this is in operation. The age check shall be made by examining either a passport, photographic driving licence or a PASS approved proof of age card. No other form of identification shall be accepted.
- (x) Fully documented staff training, to include training on the Premises Licence conditions as well as the premises' Challenge 25 Policy must be given. Training must be undertaken at regular intervals throughout the calendar year, at a minimum every 6 months. Staff must sign and date documentation at the conclusion of their training session, acknowledging that they have received and fully understood the training provided to them.

This can be made for inspection by any Responsible Authority under the Licensing Act 2003.

It is felt that the representations made are reasonable and appropriate having regard to the location. If the applicant is agreeable to the addition of conditions as proposed in the representation Gwent Police would withdraw their representations.

Authorised Officer: PC 531 Austin

Date: 17/07/20

OR 121

APPENDIX 3
Representations from 'other persons'

APPENDIX 4

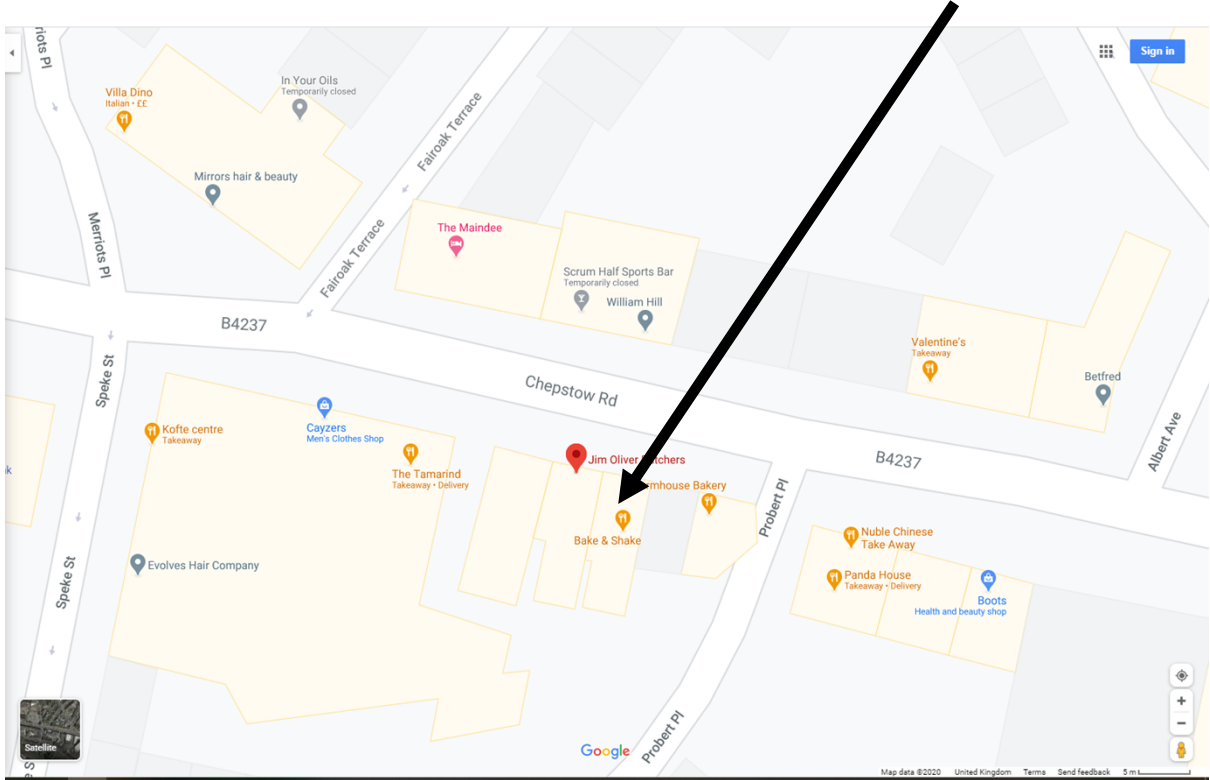

126 B4237
Newport, Wales

Google

Street View



Google